

VuLite®**4" TC REMODEL HOUSING**

INCANDESCENT LAMPS

V4TCR W

Project: _____

Fixture Type: _____

Location: _____

Contact/Phone: _____

PRODUCT DESCRIPTION

TC Remodel Housing designed for use in non-insulated areas • If installed where insulation is present, the insulation must be pulled back 3" from all sides of the TC housing • In Canada, when insulation is present, type IC fixture must be used • TC Remodel Housing for remodel application where back side of ceiling is not accessible • Installs through an opening in the ceiling from below • Secured in place by factory installed remodel springs.

PRODUCT SPECIFICATIONS

Lamp Lamp ratings based on trim selected – see reverse.

Socket Floating medium base porcelain socket with nickel-plated copper screw shell • Shipped with socket cap to protect against paint overspray.

Trims Trim selection shown on reverse.

Labels UL/cUL listed for through-branch wiring, damp locations and IP
 • Product thermally protected against improper use of lamps or insulation
 • UL/cUL Listed • Trim V4012 is wet location approved for covered ceiling applications • Trim V4034 is wet location approved for covered ceiling applications, **when used with outdoor rated lamps.**

Testing All reports are based on published industry procedures; field performance may differ from laboratory performance.

INSTALLATION

Junction Box Pre-wired junction box provided with removable access plate, (5) ½" knockouts and (4) Non-metallic sheathed cable connectors and ground wire
 • Knockouts equipped with pryout slots.

Housing TC housing, 22-gauge aluminum • Remodel springs accommodate up to a 5/8" ceiling thickness.

Warranty 1-year limited warranty. This is the only warranty provided and no other statements in this specification sheet create any warranty of any kind. All other express and implied warranties are disclaimed. Complete warranty terms located at: www.acuitybrands.com/support/warranty/terms-and-conditions

Note: Actual performance may differ as a result of end-user environment and application.
 Specifications subject to change without notice.

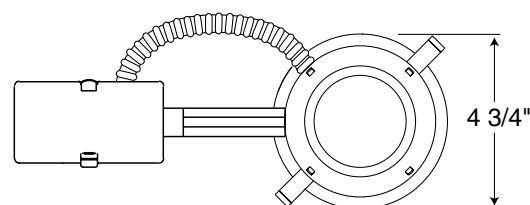
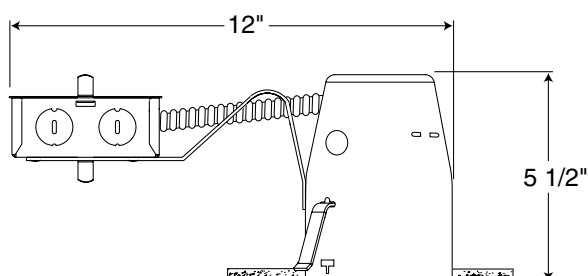
DIMENSIONS

4 3/8" CEILING CUTOUT

ACCESSORIES

Catalog No.	Description
SMPLT4	4" Housing Locator

To order, specify catalog number

PRODUCT CODES





Catalog No.	Input Voltage	Lamp Rating (max.)
V4TCR W	120V	PAR20/R20/PAR16/R16 (See reverse for max. trim rating)

4" TC REMODEL HOUSING

INCANDESCENT LAMPS

V4TCR W

TRIMS/LAMPS

	Cat. No.	Description	Max. Lamp Rating
	V4034 WWH◆◆ V4034 BWH◆◆	White Baffle Full Black Baffle	50W PAR20, 50W R20
	V4010 WH	White Gimbal Ring	50W PAR20
	V4018 WH	White Eyeball	60W PAR16, 40W R16
	V4012 WH◆	Stippled Opal Lens Shower with Reflector	50W PAR20, 50W R20

Trim Size: 5" O.D.

Trim Finish: WH - White.

Note: In Canada when insulation is present, Type IC fixtures must be used.

◆ UL/cUL Listed for use in wet location.

◆◆ UL/cUL Listed for use in wet location with outdoor rated lamp.