

FEATURES & SPECIFICATIONS

INTENDED USE — Ideal for a wide variety of low- to medium-height ceiling applications including commercial, retail and hospitality spaces where an open or damp location lensed fixture is required.

CONSTRUCTION — Heavy gauge die formed galvanized steel mounting frame with mechanical trim retention (yoke) ensures secure and flush reflector mounting to ceiling. Attached to frame are vertically adjustable mounting brackets for use with C channels, ½" steel conduit or 16 gauge flat bar hangers included, standard. Frames equipped with galvanized junction box UL Listed for through wire applications. Junction boxes equipped with (2) ¾" and (4) ½" conduit knockouts with pryout slots and removable access doors.

Maximum 1-1/2" ceiling thickness.

OPTICS — Aluminum full reflectors are optically designed to maximize lumen output and to provide superior glare control. Anodized finishes for open reflectors are semi-specular or diffuse in a variety of colors. Polyester powder coat finishes also are available in white.

Lenses are available in clear flat glass, tempered prismatic glass or polycarbonate to provide optimal visual comfort and improved aesthetics. Lens is recessed 1-3/4 (4.4) from flange.

ELECTRICAL — Electronic ballast with end of lamp life protection standard. Class P thermally protected ballast protects against improper contact with insulation. Minimum starting temperature is 0°F/-18°C. Rated for #12 AWG conductor thru-branch wiring. Minimum 90° supply wire.

Ground wire provided.

Lamp Socket Base:

TRT 4-pin lamps – 26W (GX24Q-3); 32W (GX24Q-3); 42W (GX24Q-4)

LISTINGS — Fixtures are UL Listed for thru-branch wiring, Non-IC recessed mounting, damp location, and to U.S. and Canadian Safety Standards.

WARRANTY — 1-year limited warranty. Complete warranty terms located at www.acuitybrands.com/CustomerResources/Terms_and_conditions.aspx

Specifications subject to change without notice.

Catalog Number
Notes
Type

Compact Fluorescent Downlighting

8" LF8N



OPEN REFLECTOR

Horizontal 2-Lamp, Triple Tube (TRT)

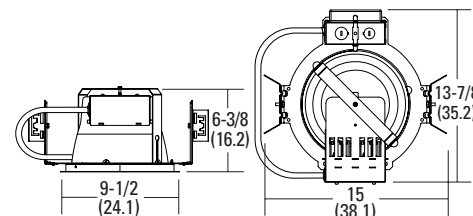

Specifications

Max. height: 6-3/8 (16.2)

Ceiling opening: 8-3/4 (22.2)

Overlap trim: 9-1/2 (24.1)

Length: 15 (38.1)

Width: 13-7/8 (35.2)

All dimensions are inches (centimeters) unless otherwise indicated.

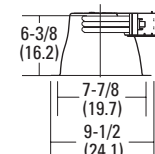

ORDERING INFORMATION

For shortest lead times, configure product using **bolded options**.

Example: LF8N 2/26-42TRT F803AZ MVOLT

LF8N	Series	Wattage/Lamp	Reflector/Color	Lens type	Voltage	Options ⁴	
LF8N	2/26-42TRT ¹ 2/26TRT 2/32TRT 2/42TRT		F803	White open	(blank) No lens	MVOLT ²	ADEZ Advance Mark 10™ electronic dimming ballast, 120V or 277V. Must be voltage specific. Minimum dimming level 5%
			F803A	Clear diffuse open	CGL Clear glass lens	120	ADZT Advance Mark 7™ electronic dimming ballast. Minimum dimming level 5%
			F803AZ	Clear semi-specular open	T73 Tempered glass prismatic lens	277	ECOS Lutron EcoSystem electronic dimming ballast, 120V - 277V. Must be wattage specific. Minimum dimming level 5% ⁷
			F803G	Gold diffuse open	PCL Clear polycarbonate lens	347 ³	EL Emergency PSDL3 DL battery pack with integral test switch. Lens removal required before EL testing ⁵
			F803GZ	Gold semi-specular open			ELR Emergency PSDL3 DL battery pack with remote test switch ⁵
			F803PR	Pewter diffuse open			ELRHL2LP Iota 1-162 Emergency battery pack with remote test switch. Operates two 26W, two 32W or two 42W CFL lamps in emergency mode with battery back-up in case of power disruption. Average output is 2600 lumens for two 26W lamps; average output is 2750 lumens for two 32W lamps; average output is 2800 lumens for two 42W lamps ⁶
			F803WTZ	Wheat semi-specular open			GMF Single slow-blow fuse, must specify voltage
							BDP Ballast disconnect plug (meets codes that require in-fixture disconnect) ³
							WLP 35K lamp (shipped separately)
							TRW White flange
				RIF1 Radio interference filter			
				LBH Less barhangers			

Accessories: Order as separate catalog number.	
SCA8	Sloped ceiling adaptor. Degree of slope must be specified (10D, 15D, 20D, 25D, 30D) Ex: SCA8 10D.
NPP16D EFP	nLight network power/relay pack with 0-10V dimming.
NPP16D ER EFP	nLight network power/relay pack with 0-10V dimming. ER controls fixtures on emergency circuit.

Notes

- 1 Not available with ECOS or WLP.
- 2 Electronic multi-volt ballast capable of operating any line voltage from 120-277V, 50 or 60Hz.
- 3 Not available with EL or ELR.
- 4 For additional options see www.lithonia.com.
- 5 Ships standard for 1-lamp operation. For 2-lamp emergency operation, consult installation instructions or factory. Add 3" (7.6) to width and 4-1/2" (11.4) to length.
- 6 Not recommended for field installation.
- 7 2/42TRT Lamp Option only available with DS (Dual Switching) option.

8" LF8N Horizontal, 2-Lamp Triple Tube (TRT), Open

PHOTOMETRICS

Distribution Curve	Distribution Data	Output Data	Coefficient of Utilization	Illuminance Data at 30" Above Floor for a Single Luminaire
--------------------	-------------------	-------------	----------------------------	--

LF8N 2/32TRT F803AZ CGL MVOLT, (2) 32W TRT Lamps, 2400 lumens per lamp, 1.6 s/mh, Test No. LTL15079

Distribution Curve	Distribution Data	Output Data	Coefficient of Utilization	Illuminance Data at 30" Above Floor for a Single Luminaire			
				Task Height: 2.5ft.			
				50% beam -		10% beam -	
				73.3°	-	101.5°	-
				Initial fc			
				Mtg Center			
				Ht	Beam	Diameter	fc Diameter
				8	35.7	8	18 13 4
				10	19.2	11	10 18 2
				12	12.0	14	6 23 1
				14	8.2	17	4 28 1
				16	5.9	20	3 33 1

LF8N 2/32TRT F803A MVOLT, (2) 32W TRT lamps, 1.6 s/mh, 4800 rated lumens, test no. LTL12058

Distribution Curve	Distribution Data	Output Data	Coefficient of Utilization	Illuminance Data at 30" Above Floor for a Single Luminaire			
				Task Height: 2.5ft.			
				50% beam -		10% beam -	
				73.5°	-	101.9°	-
				Initial FC			
				Mounting Center			
				Height	Beam	Diameter	FC Diameter
				8.0	40.7	8.2	20.3 13.5 4.1
				10.0	21.9	11.2	10.9 18.5 2.2
				12.0	13.6	14.2	6.8 23.4 1.4
				14.0	9.3	17.2	4.6 28.3 0.9
				16.0	6.7	20.2	3.4 33.3 0.7

LF8N 2/32TRT F803AZ MVOLT, (2) 32W TRT lamps, 1.6 s/mh, 4800 rated lumens, test no. LTL12057

Distribution Curve	Distribution Data	Output Data	Coefficient of Utilization	Illuminance Data at 30" Above Floor for a Single Luminaire			
				Task Height: 2.5ft.			
				50% beam -		10% beam -	
				73.8°	-	101.7°	-
				Initial FC			
				Mounting Center			
				Height	Beam	Diameter	FC Diameter
				8.0	40.2	8.3	20.1 13.5 4.0
				10.0	21.6	11.3	10.8 18.4 2.2
				12.0	13.5	14.3	6.7 23.3 1.3
				14.0	9.2	17.3	4.6 28.3 0.9
				16.0	6.7	20.3	3.3 33.2 0.7

Notes

Energy (Calculated in accordance with NEMA Standard LE-5)

Actual performance may differ as a result of end-user environment and application.



LF8N-OPEN-2-TRT